

**St Patrick's Church**  
Cambridge Road  
Hove  
East Sussex  
United Kingdom

**Hove Park School**

**Majority Place Of Worship #4**



A Christian (Anglican) place of worship,  
and The Night Shelter & Lorica Trust helping the homeless



Night Shelter (South) Entrance  
No side view possible



Church & Lorica Trust (North) Entrance  
No rear view possible



Description

The Church facing the main Altar.

Position of the object

The right (North) half of the original church, facing north.



Description

The Church facing the night-shelter.

Position of the object

The right (North) half of the original church, facing south.



Description

The main Altar, with a stained glass window by William Butterfield.

Position of the object

The north end of the church.





Size	40m x 22m (Church 20m x 22m, Night shelter 20m x 22m)
Materials	Stone (Kentish Ragstone) and slate.
Date of building/ epoch:	1858 adapted 1999.
Architect/ artist:	Henry Edward Kendall Jr.

History: including  
Renovation,  
restoration  
(when, by whom  
who paid, why?)

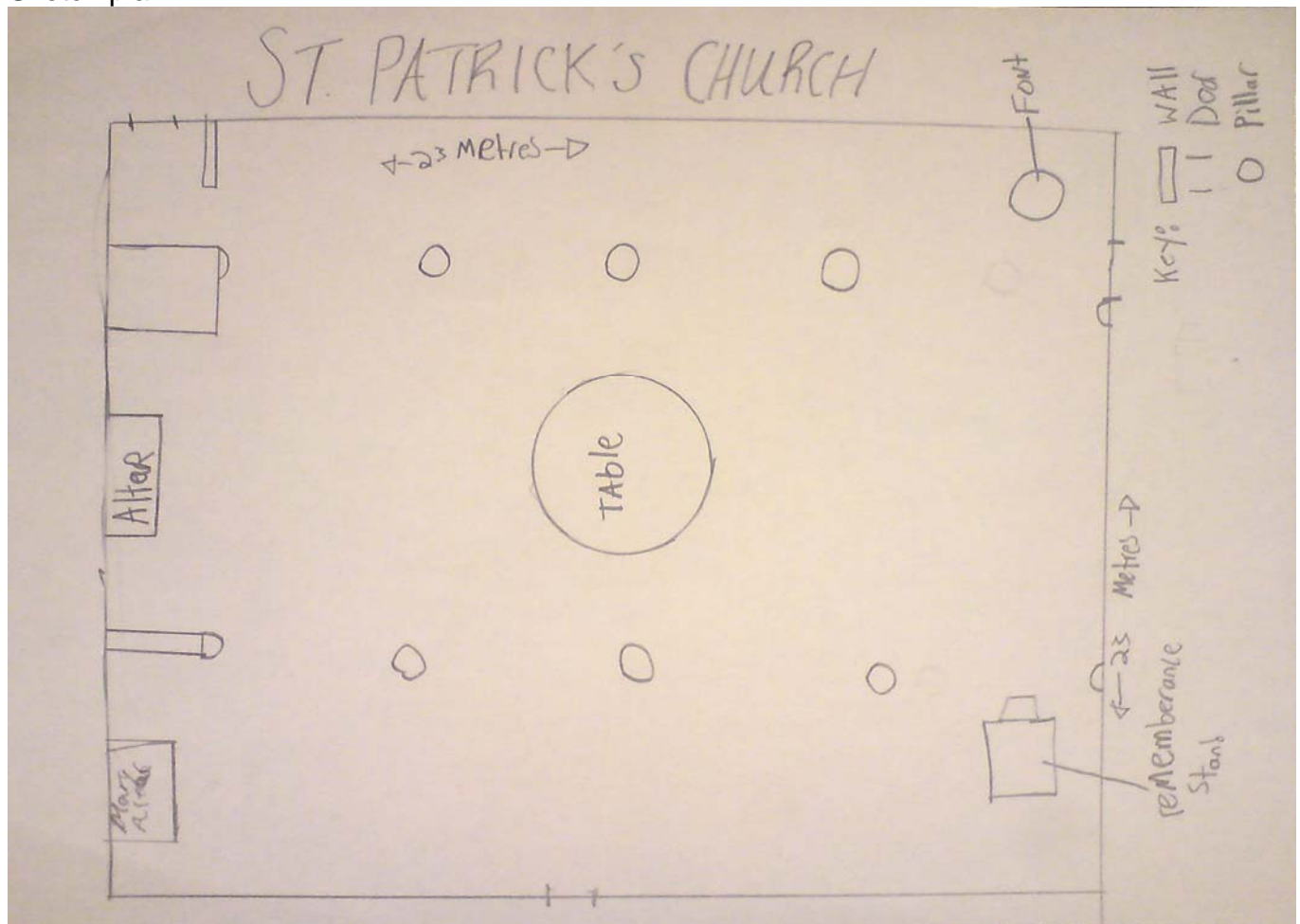
Originally built by Dr James O'Brien who made a living from the fees for marriages and funerals and charged rents for pews. The cost of construction was nearly £13,500. Construction began in July 1857 and the church was opened as *St James' Church* on 20 October 1858. It changed to *St Patrick's and St James'* in 1865, and finally became *St Patrick's* in 1868. Part of the church has been used as a night-shelter for the homeless since 1985. In 1999 the reconstruction which saw the church literally divided in half was completed.

Sketch plan:



Picture	Name	Function
	<p><b>The altar</b></p>	<p>Unusually for an Anglican Church <i>St Patricks</i> has a <b>tabernacle</b> on the main altar for storing the bread and wine</p>
	<p><b>The Lady Chapel</b></p>	<p>Again unusually for an Anglican Church <i>St Patricks</i> has a <b>Lady Chapel</b> dedicated to Mary.</p>
	<p><b>The lectern</b></p>	<p>The place from where the Vicar speaks and reads. (At <i>St Patrick's</i> the Vicar usually does this from the central table now.)</p>
	<p><b>The font</b></p>	<p>Contains water blessed by the <b>vicar</b> so that it is <b>holy water</b> here people, usually babies are <b>baptised</b>.</p>
	<p><b>St Patrick</b></p>	<p>The <b>saint</b> that the church is dedicated to.</p>



**Stained Glass**

Stained glass windows tell the stories of the **gospels** for people who cannot read them.



**The stations of the cross**

These pictures tell the story of **Jesus' crucifixion**.



**The Door to the night-shelter**

An example of Christianity in action.



**Church bell**

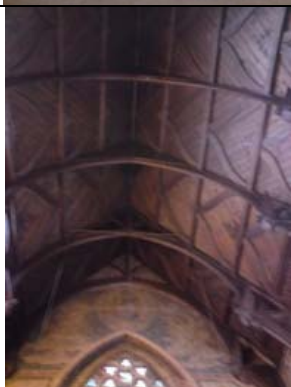

**The ceiling**